

Suction Cups

HSE

Special corrugated suction cup for spherical workpiece

HANWHA



Food grade

Ball

Product characteristics

- * Super soft large conical seal lip
- * Various special cavity structures
- * Food grade silicone material
- * Direct contact handling round, oval, shaped candy food
- * Handle food with irregular surfaces or decorative shapes
- * Multi-fold corrugated suction cups are suitable for handling foods that require soft contact, such as eggs



Product structure

- * Special sealing lip, easy to handle irregular products
- * Ultra-thin and soft conical sealing lip, suitable for handling fragile objects



Product advantages

- * Maximum product coverage for fast handling
- * Good tightness when grabbing alien candies
- * The corresponding sucker can be accurately selected according to the shape of the adsorbed food
- * Can be used in the food industry in direct contact with food



*HSE suction cups handling egg application example

Suction Cups

HSE

Special corrugated suction cup for spherical workpiece

HANWHA



Food grade

Ball



HSE Ordering NO

| | | |
|-----|---|----|
| HSE | — | 30 |
| 1 | | 2 |

| 1-Series | 2-Models | 3-Screw thread |
|----------|-----------------------------|-------------------|
| HSE | Suckers for fruits and eggs | M External thread |
| | 30 Lip diameter30mm | G02-G1/4 |
| | 33 Lip diameter33mm | G03-G3/8 |
| | 36 Lip diameter36mm | |
| | 43 Lip diameter43mm | |
| | 55 Lip diameter55mm | |



HSE Selection specification

| Models | M-G02-G1/4 | M-G03-G3/8 |
|--------|------------|------------|
| HSE30 | ⊙ | |
| HSE33 | ⊙ | |
| HSE36 | ⊙ | |
| HSE43 | ⊙ | |
| HSE55 | | ⊙ |



HSE Technical Data

| Models | Lip diameter [mm] | Suction [lbf] ⁽¹⁾ | Minimal package [pcs] | Weight [G] |
|--------|----------------------|---------------------------------|--------------------------|---------------|
| HSE30 | 30 | 0.24 | 1 | 17 |
| HSE33 | 33 | 0.24 | 1 | 8 |
| HSE36 | 36 | 0.24 | 1 | 16.36 |
| HSE43 | 43 | 1.79 | 1 | 12.6 |
| HSE55 | 55 | 2.25 | 1 | 17.3 |

(1) In 30% vacuum, the safety factor is 2

Suction Cups

HSE

Special corrugated suction cup for spherical workpiece

HANWHA

Food grade

Ball

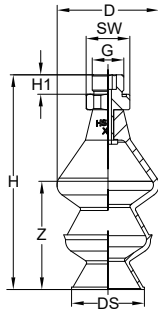

HSE Design Data

 Size[mm]⁽²⁾

| Models | D | H | H1 | G | DS | SW | Z | Weight [g] |
|------------|------|------|----|-------|----|------|------|------------|
| HSE30 | 41.8 | | | | 30 | | 44.5 | 17.23 |
| HSE30-MG02 | 41.8 | 88.4 | 8 | G1/4" | 30 | SW17 | 44.5 | 23.36 |

HSE30 External thread(egg)

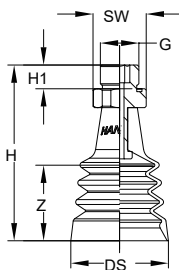
 Size[mm]⁽²⁾

| Models | H | H1 | G | DS | SW | Z | Weight [g] |
|------------|------|----|-------|----|------|----|------------|
| HSE33 | / | / | / | 33 | / | 25 | 17.23 |
| HSE33-MG02 | 59.4 | 8 | G1/4" | 33 | SW17 | 25 | 23.36 |

HSE33 External thread(egg)

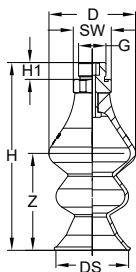
 Size[mm]⁽²⁾

| Models | D | H | H1 | G | DS | SW | Z | Weight [g] |
|------------|------|------|----|-------|------|------|----|------------|
| HSE36 | 41.1 | / | / | / | 34.5 | / | 46 | 16.66 |
| HSE36-MG02 | 41.1 | 89.1 | 8 | G1/4" | 34.5 | SW17 | 46 | 22.93 |

HSE-36 External thread

(2) Compliant with DIN ISO 3302-1 M3 rubber parts allowable dimensional tolerances. Z is the trip

Suction Cups

HSE

HANWHA



Food grade

Ball

Special corrugated suction cup for spherical workpiece

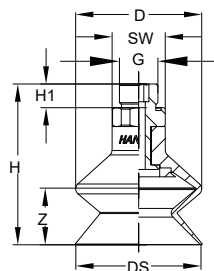

| Size[mm] ⁽²⁾ | | | | | | | | |
|-------------------------|------|------|----|-------|------|------|------|------------|
| Models | D | H | H1 | G | DS | SW | Z | Weight [g] |
| HSE43 | 42.6 | / | / | / | 42.3 | / | 19.2 | 14.01 |
| HSE43-MG02 | 42.6 | 54.4 | 8 | G1/4" | 42.3 | SW17 | 19.2 | 28.56 |

HSE43 External thread(egg)

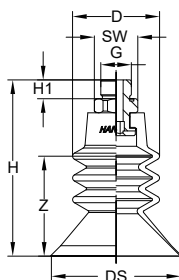

| Size[mm] ⁽²⁾ | | | | | | | | |
|-------------------------|----|----|----|-------|----|------|------|------------|
| Models | D | H | H1 | G | DS | SW | Z | Weight [g] |
| HSE55 | 37 | / | / | / | 55 | / | 42.5 | 19.17 |
| HSE55-MG02 | 37 | 75 | 8 | G3/8" | 55 | SW17 | 42.5 | 31.89 |

HSE55 External thread

(2) Compliant with DIN ISO 3302-1 M3 rubber parts allowable dimensional tolerances. Z is the trip