

Suction Cups

HSXA

Flat suction cups for packaging industry

HANWHA



Packaging



Long life

Product characteristics

- * The adaptable seal lip provides the best seal for cardboard boxes and hard packaging
- * High intrinsic stability of suction cups during dynamic processes
- * Maximum effective diameter is achieved due to the high suction of the support ribs on the suction area
- * Elastomer HX material minimizes wear (approximately 3 times longer service life than NBR)



Product structure

- * Round flat suction cups HSXA (2) with soft, flexible sealing lip and suction surface support studs made of wear-resistant elastomer HX
- * Models up to 30 mm in diameter have plug-in connection elements for quick replacement of suckers
- * Diameter from 40 mm, with 2-piece connection element: consisting of machine side assembly (1) and suction side assembly (3)
- * Clamp filter (4) as pre-filter (filter diameter 250 μm)
- * All external threaded connection elements are equipped with an integrated seal on the fastening thread

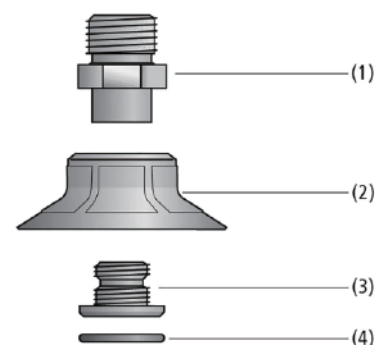

Product advantages

- * Bottom with support filter structure
- * Complete size specifications
- * Handling thin-walled workpieces will not cause permanent deformation
- * Suitable for various sizes and shapes of workpieces



*Examples of packaged workpieces handled by HSXA suction cups

Suction Cups

HSXA

Flat suction cups for packaging industry

HANWHA



Packaging



Long life



HSXA Ordering NO

HSXA	20	FG01	HX
1	2	3	4

1-Series		2-Diameter		3-Screw thread	
HSXA	1.5 Folding cups	20~60	φ20~60mm	F Internal thread	G01-G1/8
					G02-G1/4
				M External thread	G01-G1/8
					G02-G1/4
4-Material ⁽¹⁾					
HX	High performance				

(1)Other materials can also be made, please contact us



HSXA Models Selection

Models	F-G01-G1/8	M-G01-G1/8	F-G02-G1/4	M-G02-G1/4
HSXA-20	◎	◎		
HSXA-25	◎	◎		
HSXA-30	◎	◎		
HSXA-40			◎	◎
HSXA-50			◎	◎
HSXA-60			◎	◎



HSXA Technical Data

Models	Suction [N] ⁽²⁾	Lateral force [N] ⁽²⁾	Curve radius [mm]	Inner volume [cm ³]
HSXA-20	16.0	10.5	20	1.2
HSXA-25	22.7	17.0	30	1.7
HSXA-30	29.5	22.5	35	2.6
HSXA-40	49.5	25.0	70	5.0
HSXA-50	74.2	44.0	75	8.0
HSXA-60	107.0	65.0	75	12.7

(2)The surface of the workpiece is smooth and dry, and the vacuum degree is -60KPa. The above data does not include the safety factor. Depending on the surface condition of the workpiece, the value may change.

Suction Cups

HSXA

Flat suction cups for packaging industry

HANWHA



Packaging Long life

HSXA Design Data

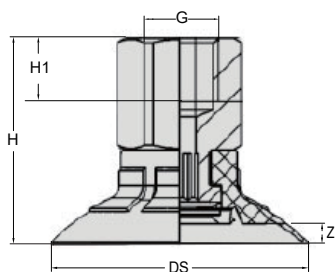

Size[mm]⁽³⁾

Models	H	H1	G	DS	SW	Z	Weight [g]
HSXA-20-FG01	25	8	G1/8"	21.4	SW14	2.0	7
HSXA-25-FG01	25	8	G1/8"	26.4	SW14	2.0	7
HSXA-30-FG01	26	8	G1/8"	31.4	SW14	2.5	8
HSXA-40-FG02	33	12	G1/4"	41.4	SW17	2.5	19
HSXA-50-FG02	34	12	G1/4"	51.4	SW17	3.5	20
HSXA-60-FG02	36	12	G1/4"	61.2	SW17	5.1	23

HSXA20-60 Internal thread

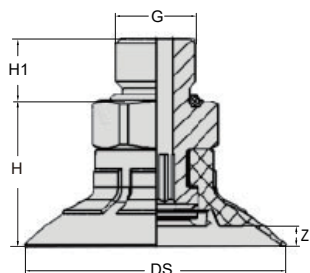

Size[mm]⁽³⁾

Models	H	H1	G	DS	SW	Z	Weight [g]
HSXB-20-MG01	17	7.5	G1/8"	21.4	SW14	2.0	6
HSXB-25-MG01	17	7.5	G1/8"	26.4	SW14	2.0	6
HSXB-30-MG01	18	7.5	G1/8"	31.4	SW14	2.5	7
HSXB-40-MG02	23	10.0	G1/4"	41.4	SW17	2.5	18
HSXB-50-MG02	24	10.0	G1/4"	51.4	SW17	3.5	19
HSXB-60-MG02	26	10.0	G1/4"	61.2	SW17	5.1	22

HSXA20-60 External thread

(3) Compliant with DIN ISO 3302-1 M3 rubber parts allowable dimensional tolerances. Z is the trip